

# Soils Map

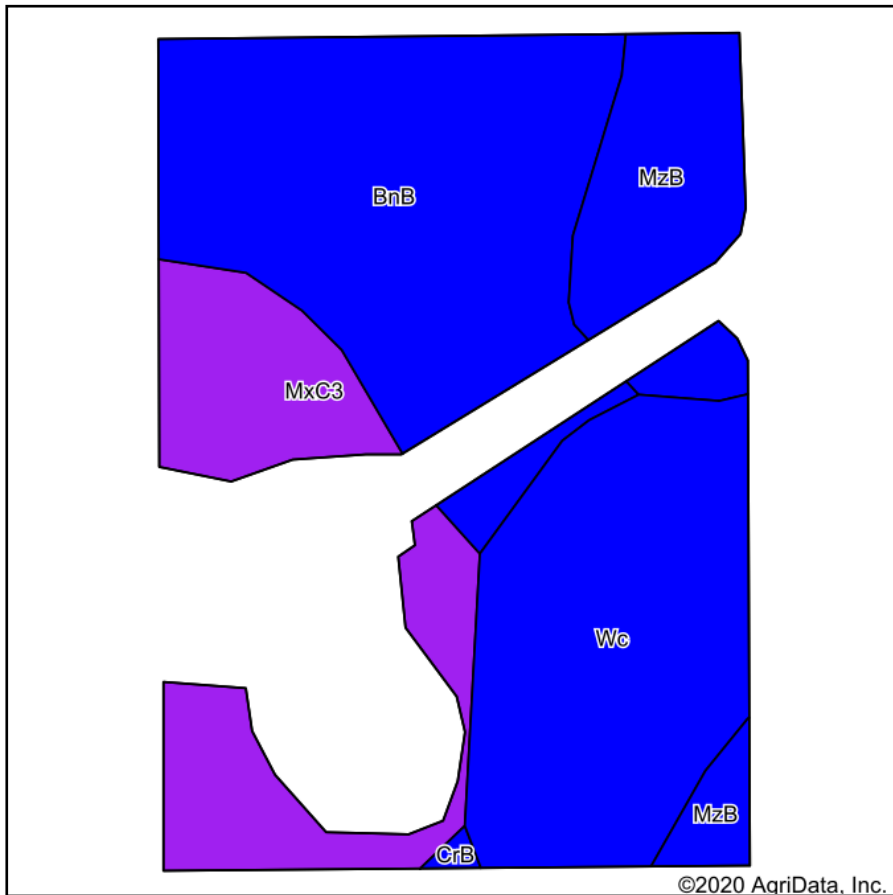

Soils data provided by USDA and NRCS.

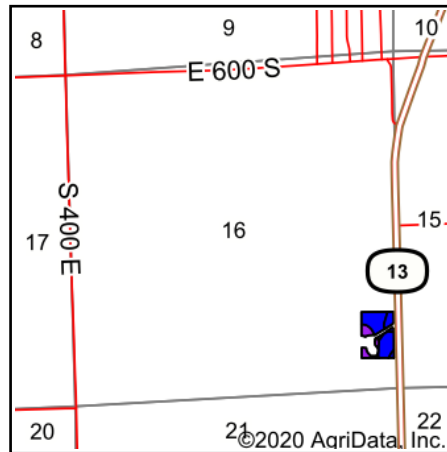

State: **Indiana**  
 County: **Kosciusko**  
 Location: **16-31N-7E**  
 Township: **Monroe**  
 Acres: **6.82**  
 Date: **11/13/2020**



Area Symbol: IN085. Soil Area Version: 23

Code	Soil Description	Acres	Percent of field	Non-Irr Class Legend	Non-Irr Class *c	Corn	Soybeans	*n NCCPI Soybeans
BnB	Blount-Glynwood complex, 1 to 3 percent slopes	2.57	37.7%		Ile	123	41	49
Wc	Washtenaw silt loam	1.98	29.0%		Ilw	165	49	80
MxC3	Morley silty clay loam, 5 to 15 percent slopes, severely eroded	1.34	19.6%		Vle	105	37	27
MzB	Morley-Glynwood complex, 1 to 4 percent slopes	0.93	13.6%		Ile	130	46	55
<b>Weighted Average</b>						<b>132.6</b>	<b>43.2</b>	<b>*n 54.5</b>

\*n: The aggregation method is "Weighted Average using all components"

\*c: Using Capabilities Class Dominant Condition Aggregation Method

Soils data provided by USDA and NRCS.