

# Soils Map

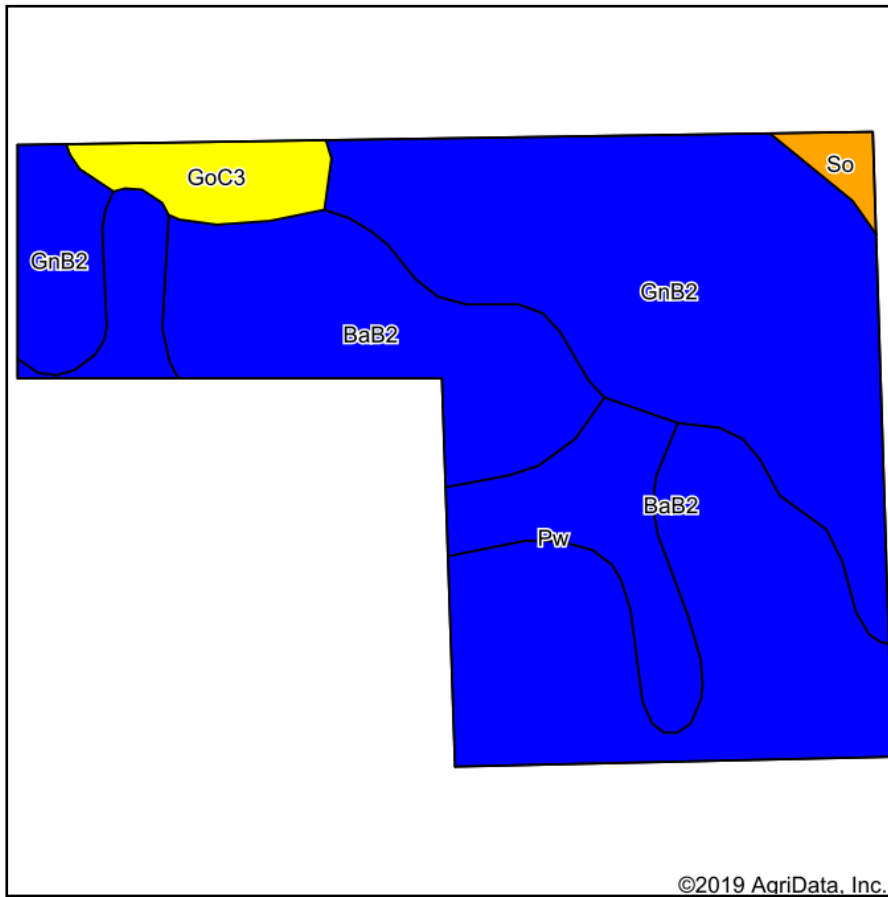

Soils data provided by USDA and NRCS.

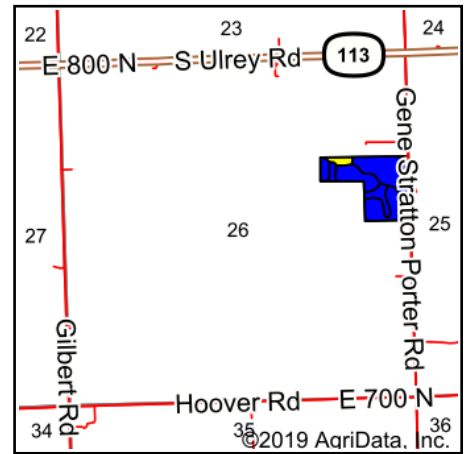

State: **Indiana**  
 County: **Wabash**  
 Location: **26-29N-7E**  
 Township: **Chester**  
 Acres: **21.44**  
 Date: **11/8/2019**



Area Symbol: IN169, Soil Area Version: 24

Code	Soil Description	Acres	Percent of field	Non-Irr Class Legend	Non-Irr Class *c	Corn	Soybeans	*n NCCPI Soybeans
BaB2	Blount loam, interlobate moraines, 1 to 4 percent slopes, eroded	9.03	42.1%		Ile	137	50	30
GnB2	Glynwood silt loam, 2 to 6 percent slopes, eroded	8.64	40.3%		Ile	128	44	26
Pw	Pewamo silty clay loam, 0 to 1 percent slopes	2.54	11.8%		Ilw	157	47	67
GoC3	Glynwood clay loam, 5 to 12 percent slopes, severely eroded	0.96	4.5%		IVe	120	42	17
So	Sloan silty clay loam, 0 to 1 percent slopes, frequently flooded	0.27	1.3%		IIIw	134	47	50
<b>Weighted Average</b>						<b>134.9</b>	<b>46.8</b>	<b>*n 32.4</b>

\*n: The aggregation method is "Weighted Average using major components"

\*c: Using Capabilities Class Dominant Condition Aggregation Method

Soils data provided by USDA and NRCS.